



UNIT TYPE 1B-S1

The Springbrook

-  **1 Open plan bedroom**
-  **1 Spare bedroom**
-  **1 Bathroom**

Internal Area 58.7m²
Balcony Area 8.5m²
Total Area 67.2m²
(7.2 Squares)

Features

- » Open plan apartment with spare room that can be used as a guest room or for storage
- » Professionally designed interiors including fixtures and finishes of the highest standard
- » Large balcony with no threshold for easy access
- » Wide hallway and doorway
- » Wheelchair accessible kitchen
- » Hob-less shower
- » Accessible sinks in bathroom, kitchen and laundry
- » Grab rail in bathroom
- » Facilities for bed hoist if required

Unit Numbers

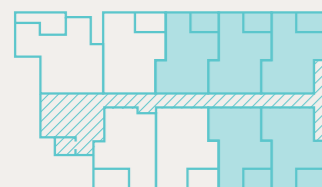

IPANEMA
205, 206
207, 208
209



 Springbrook National Park covers 6558ha with spectacular waterfalls and rainforest walks.

Odyssey LIFESTYLE CARE COMMUNITIES